

breathe

inhale life

PREMIERE ISSUE



LILI TAYLOR GETS LIGHT **TANTRIC SEX** DECODED
BARCELONA BARED **EDWARD NORTON** GOES SOLAR
15-MINUTE YOGA PRACTICE + ARCHITECTURE, DESIGN,
 TRAVEL, SPIRIT, FASHION, ESSAYS, OBJECTS, MUSIC, ART, BOOKS, HEALING, FOOD, PROFILES, PLANET

Premiere 2004

\$6.95US \$6.95CAN 11>

09281 01128 6

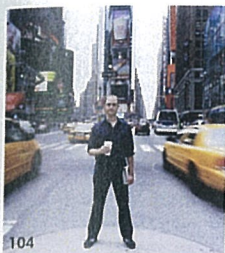

104



82

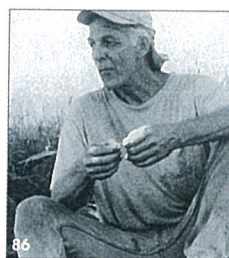

86

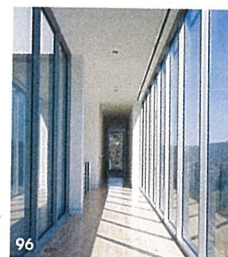

96



108

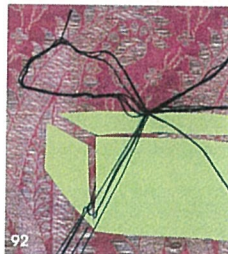

92

features

82
lili taylor
illuminated
The actor talks to
Elizabeth Weitzman
about staying inspired
and delving deep.

On the cover: Lili Taylor was photographed on Cape Cod by Noe DeWitt. Styling: Phyllis Leibowitz. Hair: Benoit Moyaert for Joe Management. Makeup: Eric Polito for the Wati Group. Special thanks to Mark Adams. Clothing: Camisole by Felina, jacket by Shelly Steffee, jeans by True Religion.

86
a day in
the mind of a
shepherd
Writer Gillian Aldrich
spends time with
Eugene Wyatt while
he converses with his
flock and reaps the
karma of the land.

92
the package
A tussle with India's
notorious postal
system shows writer
Gayle Forman that
conjuring calm is not
a Western luxury but
an Eastern necessity.

96
outside in
This dramatic Bel Air
home combines steel,
glass, and a healthy
respect for nature.
by Heather Bradley

104
the striver
& the seeker
Two old friends—
a die-hard New Yorker
and a would-be
monk—talk about
satisfaction, responsi-
bility, and why anyone
would want to be
Buddha's janitor.
by Noah Robischon
and Ted Rose

108
cosmic weaver
In Peru's upper
Amazon, author
Louise Danielle
Palmer encounters
a shaman who uses
songs to heal the soul.

114
urban seascape
Photographer
Matt Jones shoots
lush fall fashions
on eco-model
Angela Lindvall.

portfolio

phenomena

with water, fog, sand, and light, artist Ned Kahn creates installations that unite nature and science



COURTESY, TECHNORAMA

breathe *121*

portfolio

Breathing Sky, 1995

Center for the Arts

Yerba Buena Gardens, San Francisco

Fog billows from a 20-foot-diameter ring of stones, shifting direction with each gust of wind and reflecting the changing colors of the sky.

Previous page: *Fire Vortex*, 1997

Technorama, Winterthur, Switzerland

A swirling column of fire two stories high rises from a pool of kerosene inside a dark atrium. Viewers watch from a balcony, safely removed from the roaring vortex.

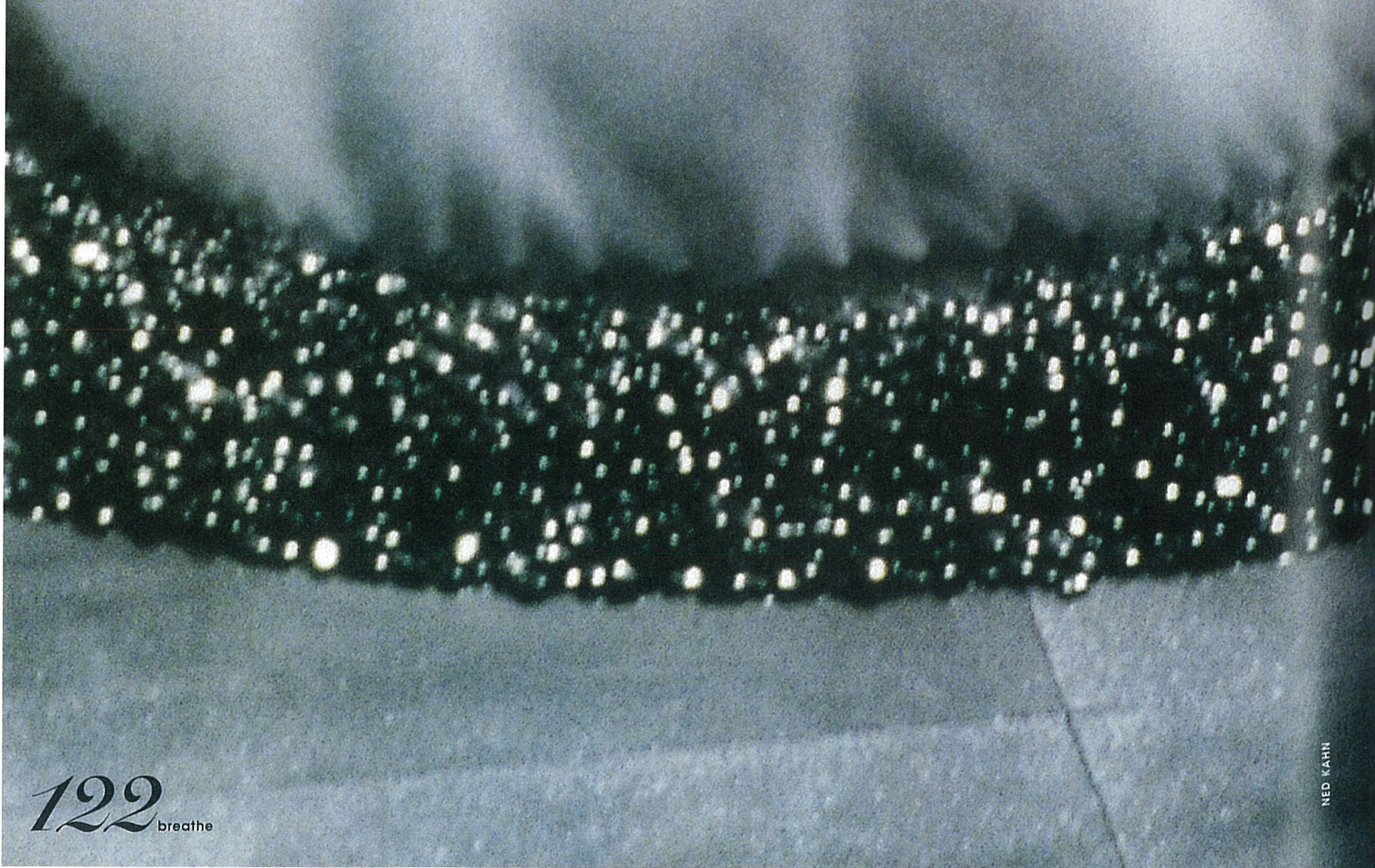

Digital Wind, 1987

Headlands Center for the Arts, Sausalito, California
Sunlight and air filter through a curtain made of small, jointed parts. The breeze rustles the panel, setting in motion intricate patterns of light.

portfolio

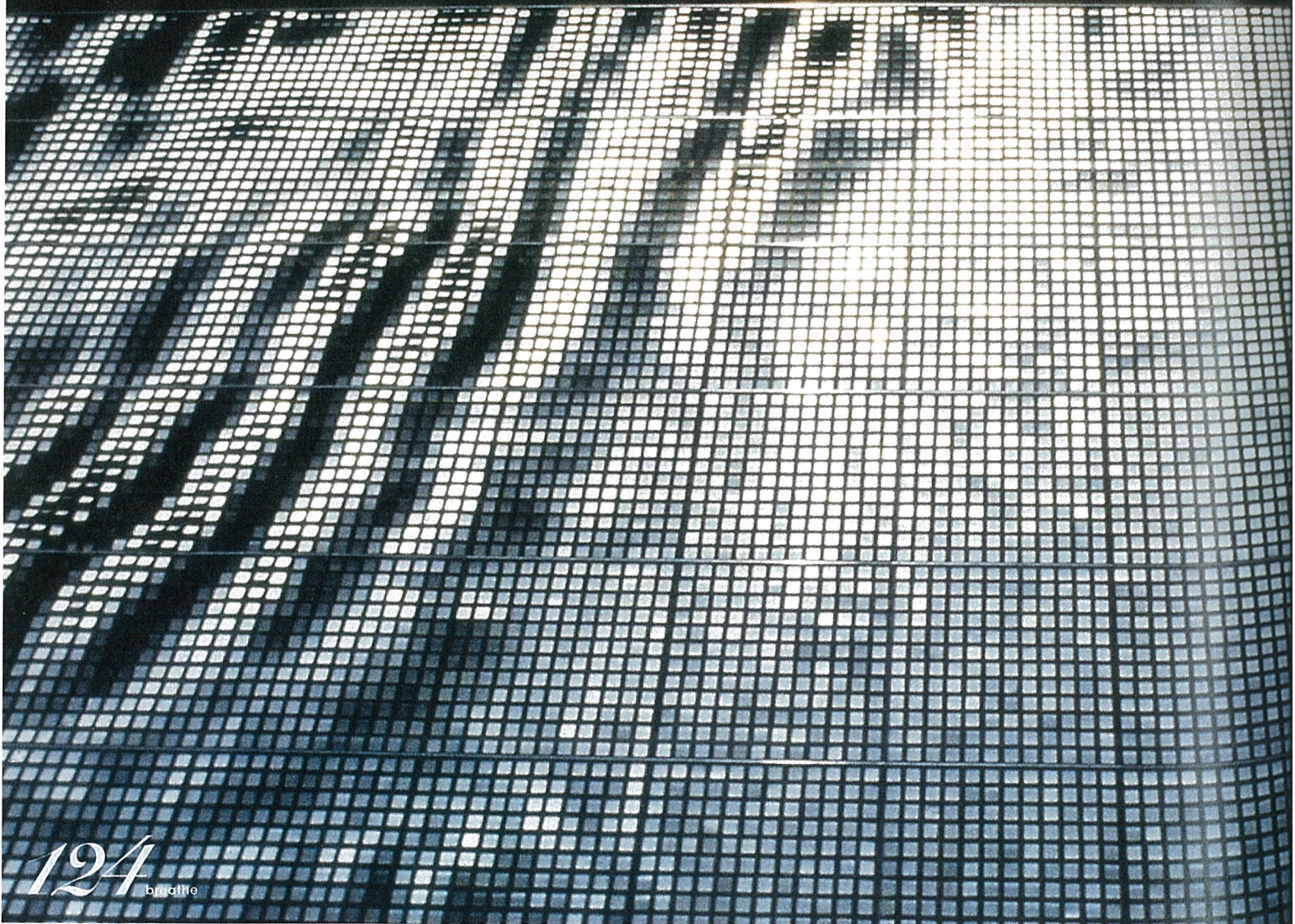

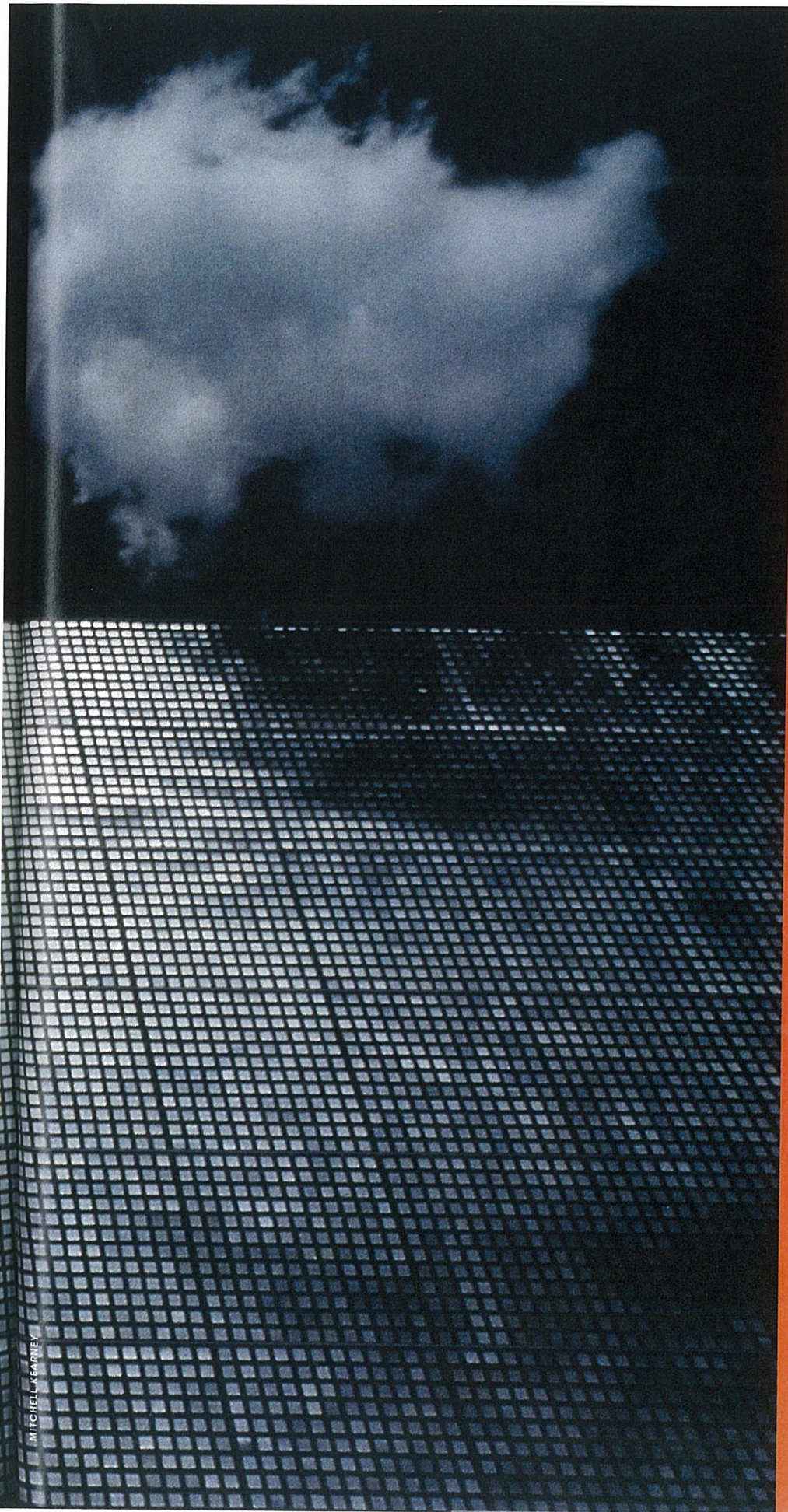

IM TICHELL & EARNEY

Wind Veil 8, 2000

Gateway Village, Charlotte, North Carolina

Kahn blanketed the exterior of this parking garage with 80,000 small aluminum panels hinged to move freely in the wind. Air currents generate waves, as if in a field of metallic grass.

Sonic Range, 1992

Exploratorium, San Francisco

In this 30-inch-diameter disc, copper powder piled on a vibrating membrane forms visible fault lines, subduction zones, and geysers, just as the earth does when it quakes.



Core, 1998

Los Angeles Municipal Art Gallery

Air bubbling up through a mixture of glass beads and ground-glass pigments creates the impression of a slice through a volcanic landscape.

Encircled Stream, 1995

(collaboration with Atelier Landscape Architects)

Founders Court, Seattle Center

This whirlpool rhythmically fills and drains every few minutes, suggesting the countless floods that sculpted the terrain of eastern Washington.

Dry Wave, 2004

Off the Preserve Gallery, Napa, California

As tiny glass beads ride a spinning disk, the energy of their motion becomes visible in the shape of waves.

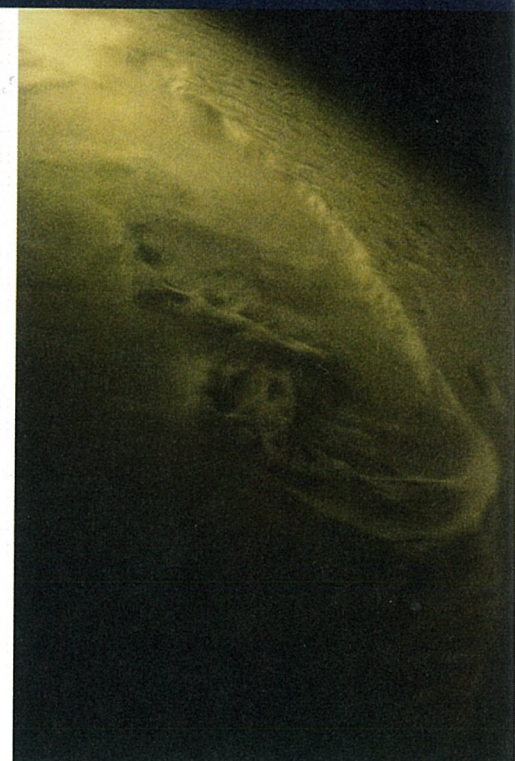
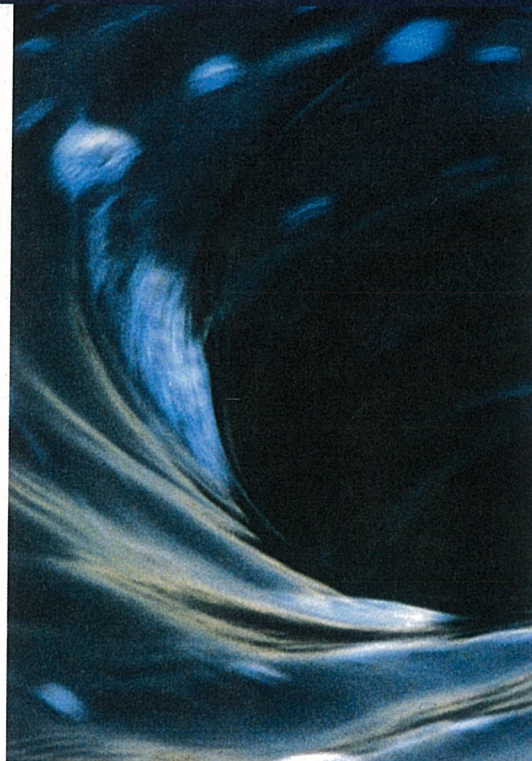
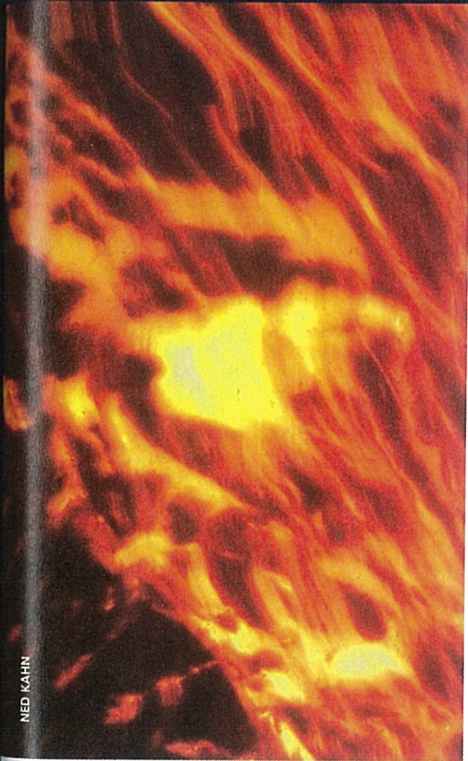

NED KAHN

WHEN WEARY TRAVELERS at San Francisco International Airport stumble off their planes and head down to the BART station, they may notice a ripple of light overhead. Unsure if it's mirrors, water, or something else, they might look up and stare, fatigue forgotten. Above they'll see small discs of stainless steel—200,000 of them—dancing with the wind and reflecting light and color. In ensemble, these elements cause the circles to create a changing

image, resembling the surface of a stream, with lighter and darker parts flowing past each other. This Ned Kahn installation brings viewers into the moment and sends them on their way refreshed.

"I try to create simple, calming environments with one or two soothing but intricate phenomena to observe," Kahn says. From 1982 to 1996, the 44-year-old artist was a protégé of famed physicist Frank Oppenheimer, founder and director of San

Francisco's Exploratorium, an interactive museum that integrates art and science. Last year Kahn's work with elemental materials such as air, fire, and water brought him a MacArthur Foundation "genius" grant. Although the forces he utilizes are powerful, even dangerous, Kahn's approach is gentle. "My work has been informed by my practice of Buddhism," he says. "I frame little pieces of time and space and let something unfold in them." ○○○○

Portfolio text and captions by Meredith Tromble